

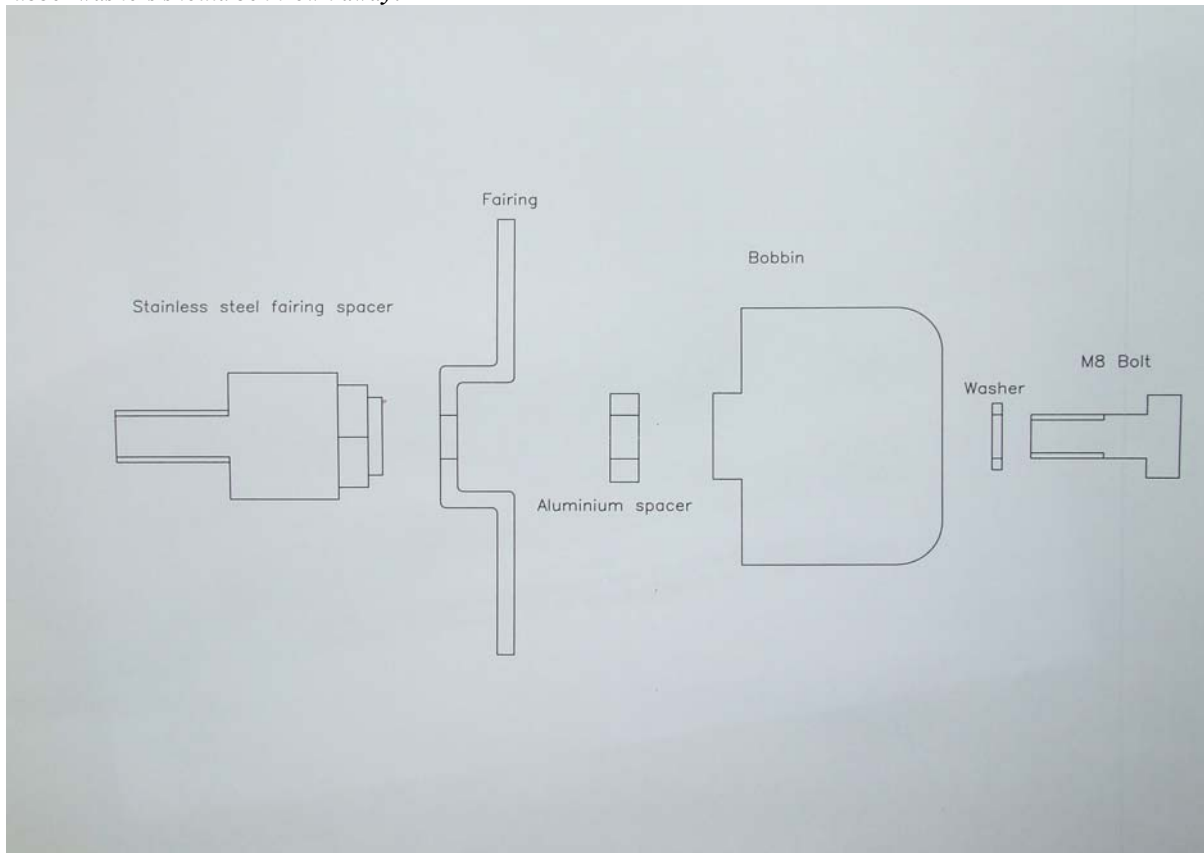

PLEASE NOTE THAT THE WAY THE KIT IS PACKED DOES NOT NECESSARILY REPRESENT THE WAY OF MOUNTING TO THE BIKE

**FITTING INSTRUCTIONS FOR CP0012BL/WH CRASH PROTECTORS
Honda CBR600F '99-'08 Aluminium Frame**

Please note that in cases where kits are packed with rubber washers holding the components onto the bolt – *the rubber washers should be thrown away!*



- Remove fairing screw nearest front of seat.
- Unscrew steel frame-to-fairing spacer.
- Screw the R&G stainless steel frame to fairing spacer into the frame and tighten.
- Slide one of the washers on to one of the M8 x 50 bolts .
- Insert M8 x 50 mm high tensile steel bolt through crash protector.
- Slide one of the small aluminium spacers over the bolt and up to the crash protector.
- Pass the assembly through the fairing and screw into the R&G frame spacer.
- Tighten bolt until you feel some compression from inside the protector. Turn a little more so that you feel the compression increase slightly. Then apply a quarter turn. Do not overtighten as damage can occur to the bike. Do not exceed 40nm of torque.
- Repeat other side.

Due to the risk of cross-threading of bolts etc; we always recommend that our products be fitted by one of our official dealers or a qualified mechanic.

R&G Racing
Unit 5K, Blacknest Industrial Park, Blacknest Road, Alton, Hampshire, GU34 4PX
Tel: +44 (0)870 220 6380 Fax: +44 (0)1420 521101 www.rg-racing.com Email: info@rg-racing.com



CONSUMER NOTICE

The catalogue description and any exhibition of samples are only broad indications of the Products and R&G may make design changes which do not diminish their performance or visual appeal and supplying them in such state shall conform to the order. The Buyer acknowledges no representation or warranty (other than as to title) has been given or will apply to the Products other than those in R&G's order or confirmation and the Buyer confirms it has chosen the Products as being of merchantable quality and suitable for its particular purposes. Where R&G fits the Products or undertakes other services it shall exercise reasonable skill and care and rectify any fault free of charge unless the workmanship has been disturbed. The Buyer is responsible for ensuring that the warranty on the motorcycle is not affected by the fitting of the Products. On return of any defective Products R&G shall at its option either supply a replacement or refund the purchase money but shall not be liable if the Products have been modified or used or maintained otherwise than in accordance with R&G's or manufacturer's instructions and good engineering practice or if the defect arises from accident or neglect. Other than identified above and subject to R&G not limiting its liability for causing death and personal injury, it shall not be liable for indirect or consequential loss and otherwise its liability shall be limited to the amounts paid by the Buyer for the Products or the fitting or service concerned. These terms do not affect the Buyer's statutory rights.

R&G RACING RETURNS POLICY (NON-FAULTY GOODS)

Returns must be pre-authorized (if not pre-authorized the return will be rejected). Goods may only be returned direct to us if they were purchased direct from us (customer must prove if necessary). Otherwise to be returned to original vendor. Goods must be in re-sellable condition, in the opinion of R&G Racing. All returns are subject to a 25% restocking and handling fee (25% of the gross value exc. P&P – at the prevailing price at time of purchase). The customer must pay any and all carriage charges. No returns of discontinued products, unless within 14 days of purchase. This policy does not affect your statutory rights and does not refer to faulty goods.

R&G Racing

Unit 5K, Blacknest Industrial Park, Blacknest Road, Alton, Hampshire, GU34 4PX

Tel: +44 (0)870 220 6380 Fax: +44 (0)1420 521101 www.rg-racing.com Email: info@rg-racing.com



Notice de montage

CP0012 HONDA 600F CBR '99-'08

Le sens de montage n'est pas identique au sens présenté dans l'emballage, merci de suivre les instructions ci dessous.

Dans le cas où les kits sont emballés avec un joint torique, celui-ci doit être retiré avant le montage.

Conseil de montage:

- œ Démontez la vis de fixation de carénage à l'avant de la selle.
- œ Enlevez l'entretoise en acier se trouvant dans l'entretoise du carénage.
- œ Placez la vis M8x 80mm à travers un tampon R&G.
- œ Fixez ensuite le tampon sur la moto (cf schéma suivant.)

VOCABULAIRE:

BOBBIN *Tampon*

ENGINE SPACER *Entretoise de moteur*

FAIRING *Carénage*

ALI SPACER *Entretoise en aluminium*

WASHER *Rondelle*

BOLT *VIS*

- œ Une fois monté, Serrez la vis M8. Serrez jusqu' au serrage complet de la protection, ne pas serrez trop fort car cela peut abimer le deux roues. Ne pas serrer à plus de 40nm.

REFAIRE LES MEMES OPERATIONS POUR L'AUTRE CÔTE.

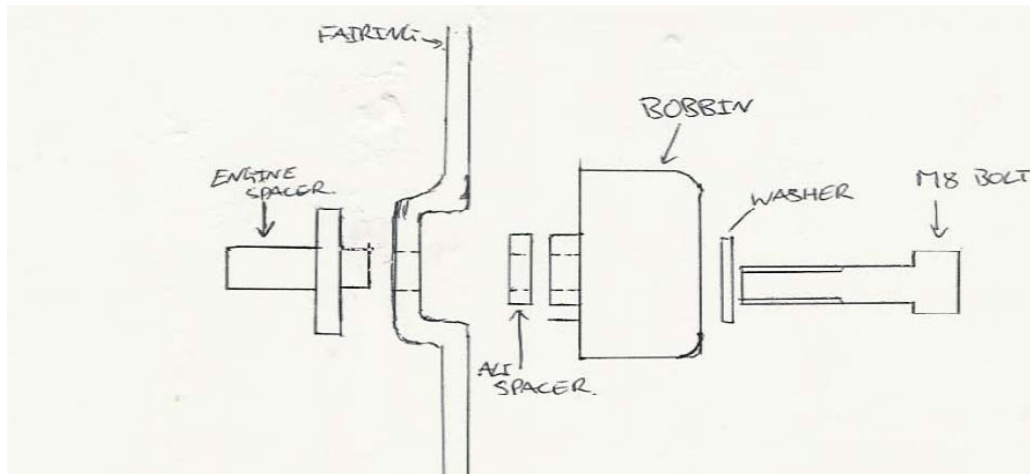

R&G Racing

Unit 5K, Blacknest Industrial Park, Blacknest Road, Alton, Hampshire, GU34 4PX

Tel: +44 (0)870 220 6380 Fax: +44 (0)1420 521101 www.rg-racing.com Email: info@rg-racing.com



R&G Racing
Unit 5K, Blacknest Industrial Park, Blacknest Road, Alton, Hampshire, GU34 4PX
Tel: +44 (0)870 220 6380 Fax: +44 (0)1420 521101 www.rg-racing.com Email: info@rg-racing.com