



FITTING INSTRUCTIONS FOR AB0005BK ADVENTURE BARS
SUZUKI DL650 V-STROM



PICTURE A



PICTURE B

THIS KIT CONTAINS THE ITEMS PICTURED AND LABELLED BELOW.
DO NOT PROCEED UNTIL YOU ARE SURE ALL PARTS ARE PRESENT.

Please note that the way the kit is packed does not necessarily represent the way of mounting to the bike

THE PARTS SHOWN MAY BE REPRESENTATIVE ONLY (FOR CLARITY OF INSTRUCTIONS ONLY)

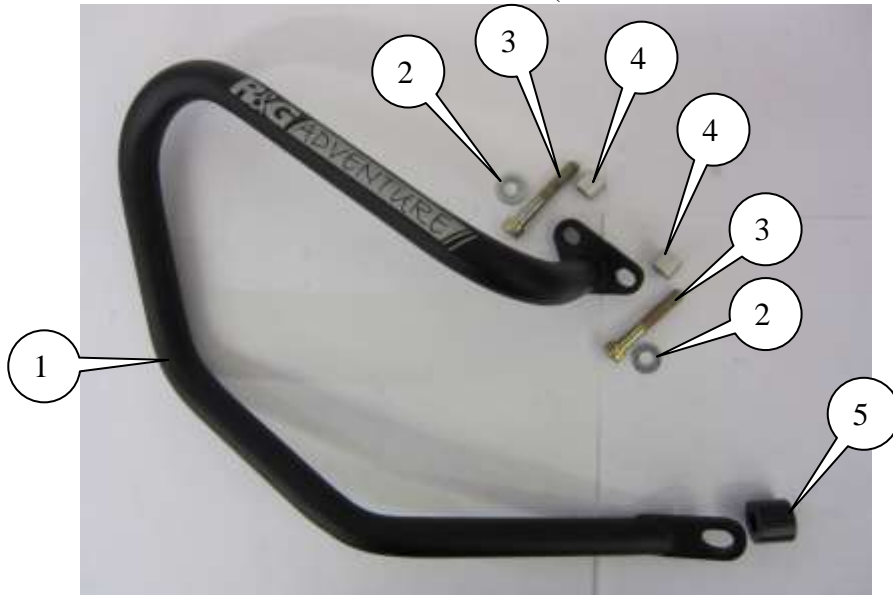

LEFT HAND SIDE



THIS KIT CONTAINS THE ITEMS PICTURED AND LABELLED BELOW.
DO NOT PROCEED UNTIL YOU ARE SURE ALL PARTS ARE PRESENT.

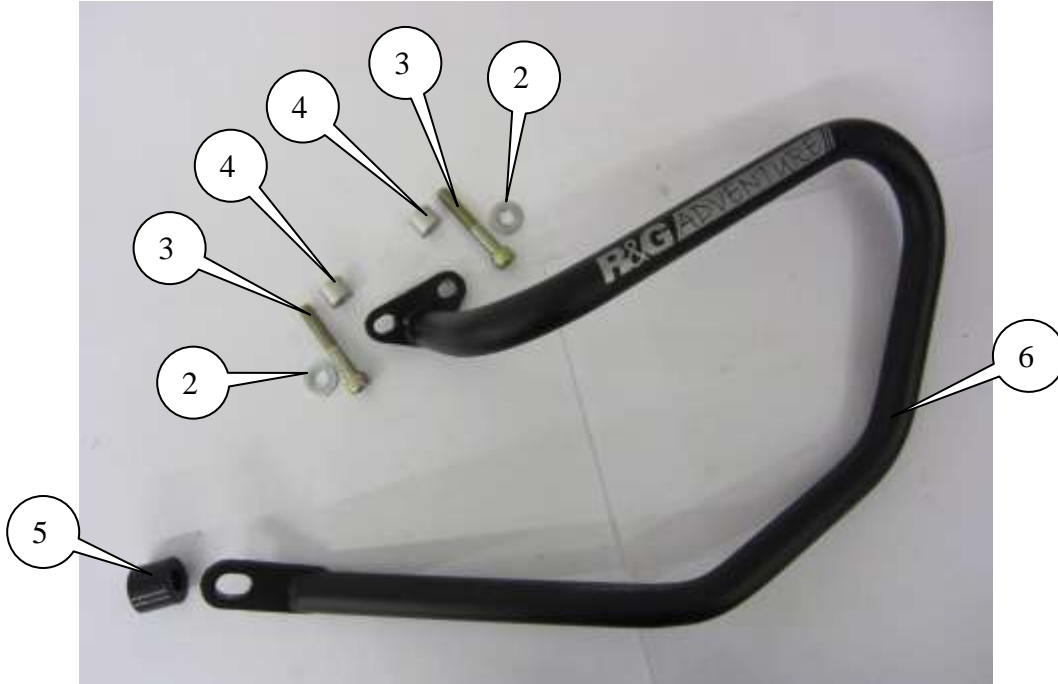

RIGHT HAND SIDE

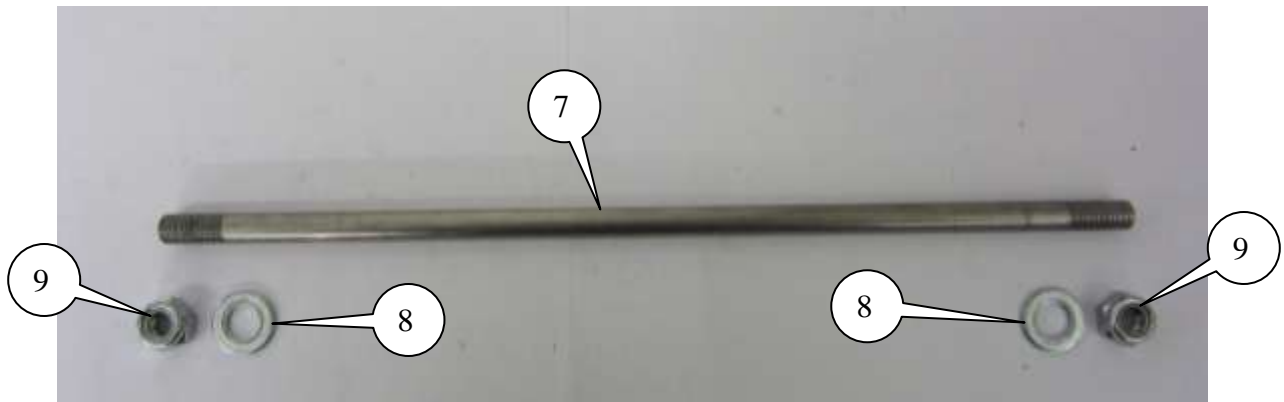

ADDITIONAL ITEMS



LEGEND

- ITEM 1 = ADVENTURE BAR LEFT-HAND SIDE (CB015) (x1).
- ITEM 2 = M8 WASHERS, TWO PER SIDE (x4).
- ITEM 3 = M8x1.25x50mm LONG CAP HEADED BOLTS (L AND R-H-S UPPER) (x4).
- ITEM 4 = L&R-H-S UPPER SPACERS (12mm LONG) (S0138) (x4).
- ITEM 5 = L&R-H-S LOWER SPACERS (21mm LONG) (S0027) (x2).
- ITEM 6 = ADVENTURE BAR RIGHT-HAND SIDE (CB016) (x1).
- ITEM 7 = 12mm ENGINE BAR (380mm LONG) (EB0006) (x1).
- ITEM 8 = M12 WASHERS (L&R-H-S) (x2).
- ITEM 9 = M12 NYLOC NUTS (x2).

TOOLS REQUIRED

- Socket set to include 2x 17 and 19mm sockets and wrenches.
 - Set of Allen keys to include 6mm A/F.
 - Torque wrench (up to 40Nm).



PICTURE 1



FITTING INSTRUCTIONS

Left-hand side (as you sit on bike)

- Remove the engine/frame mounting bolts labelled 'A' and 'B' in picture 1.
- Remove the engine bolt labelled 'C' in picture 1 (you will need to hold the nut on the right hand side).
- Place two of the M8 bolts (items 3=50mm long) with washers (items 2) through the upper mounting plate of the left-hand side adventure-bar (item 1) as labelled 'A' and 'B' in picture 1.
- Place two of the smallest spacers (items 4=12mm long) over the exposed end of the bolts.
- Offer the adventure bar assembly into position as shown in picture A (do not tighten at this stage).
- Place one of the M12 washers (item 8) and one of the M12 nyloc nuts (item 9) onto the engine bar (item 7) ensure the nut is fully engaged.
- Place one of the larger spacers (item 5) into the frame recess labelled 'C' in picture 1.
- Push the engine bar (item 7) with nut and washer through the lower mounting plate of the adventure bars and through the lower spacer (item 5) as shown in picture 1.
- Tighten the two upper bolts to no more than 20Nm.

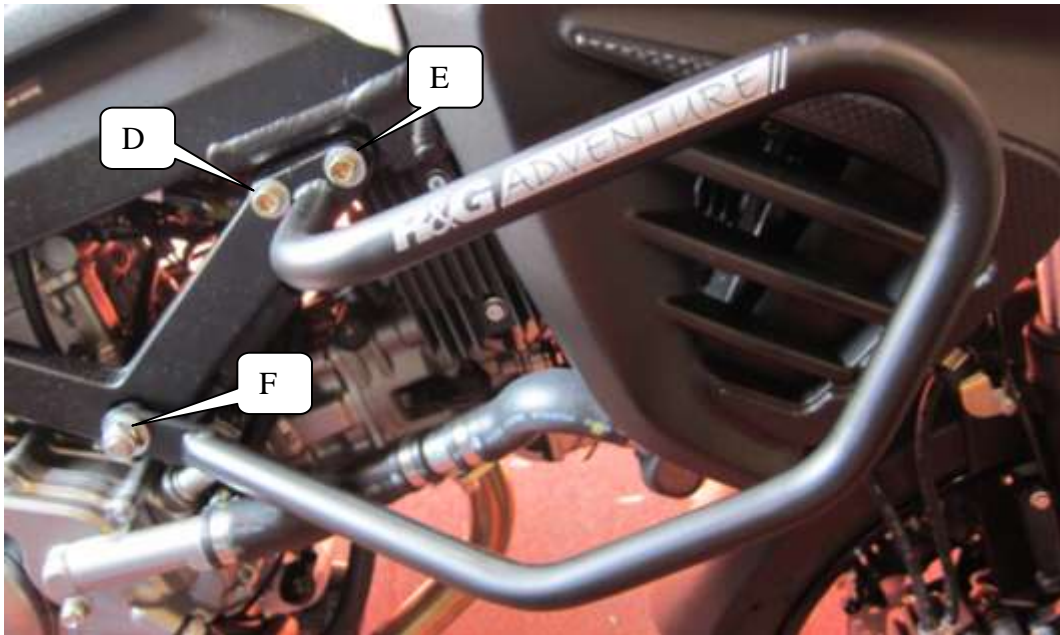

PICTURE 2

Right-hand side (as you sit on bike)

- Remove the two engine/frame mounting bolts labelled 'D' and 'E' in picture 2.
- Place the remaining lower spacer (item 5) into the frame recess and over the exposed end of the engine bar (in position labelled 'F' in picture 2).



- Place the two remaining M8 bolts (items 3=50mm long) with washers (items 2) through the upper mounting plate of the right-hand side adventure-bar (item 6) as labelled 'D' and 'E' in picture 2.
- Place two of the smallest spacers (items 4=12mm long) over the exposed end of the bolts.
- Offer the adventure bar assembly into position as shown in picture 2 (do not tighten at this stage).
- Place one of the M12 washers (item 8) and one of the M12 nyloc nuts (item 9) onto the exposed end engine bar (item 7) ensure the nut is fully engaged.
- Tighten the two upper bolts to no more than 20Nm.
- Tighten the lower M12 nyloc nut (you will have to hold the other M12 nyloc nut from the left hand side) to no more than 40Nm ensuring both nuts are fully engaged.

ISSUE 1 22/05/2012 (NSY)

CONSUMER NOTICE

The catalogue description and any exhibition of samples are only broad indications of the Products and R&G may make design changes which do not diminish their performance or visual appeal and supplying them in such state shall conform to the order. The Buyer acknowledges no representation or warranty (other than as to title) has been given or will apply to the Products other than those in R&G's order or confirmation and the Buyer confirms it has chosen the Products as being of merchantable quality and suitable for its particular purposes. Where R&G fits the Products or undertakes other services it shall exercise reasonable skill and care and rectify any fault free of charge unless the workmanship has been disturbed. The Buyer is responsible for ensuring that the warranty on the motorcycle is not affected by the fitting of the Products. On return of any defective Products R&G shall at its option either supply a replacement or refund the purchase money but shall not be liable if the Products have been modified or used or maintained otherwise than in accordance with R&G's or manufacturer's instructions and good engineering practice or if the defect arises from accident or neglect. Other than identified above and subject to R&G not limiting its liability for causing death and personal injury, it shall not be liable for indirect or consequential loss and otherwise its liability shall be limited to the amounts paid by the Buyer for the Products or the fitting or service concerned. These terms do not affect the Buyer's statutory rights.

R&G RACING RETURNS POLICY (NON-FAULTY GOODS)

Returns must be pre-authorized (if not pre-authorized the return will be rejected). Goods may only be returned direct to us if they were purchased direct from us (customer must prove if necessary). Otherwise to be returned to original vendor. Goods must be in re-sellable condition, in the opinion of R&G Racing. All returns are subject to a 25% restocking and handling fee (25% of the gross value exc. P&P – at the prevailing price at time of purchase). The customer must pay any and all carriage charges. No returns of discontinued products, unless within 14 days of purchase. This policy does not affect your statutory rights and does not refer to faulty goods.



Instructions de montage

AB0005BK Barres Aventure
SUZUKI DL650 V-STROM



Photo A



Photo B

Vérifier le contenu de la boîte avant de déballer les pièces. Ne pas procéder au montage s'en s'être assuré au préalable que les articles soient bien présents.

La façon dont le kit est emballé ne représente pas nécessairement la façon de le monter sur la moto.

Les parties représentées peuvent parfois être uniquement représentatives

(Pour la clarté des explications).

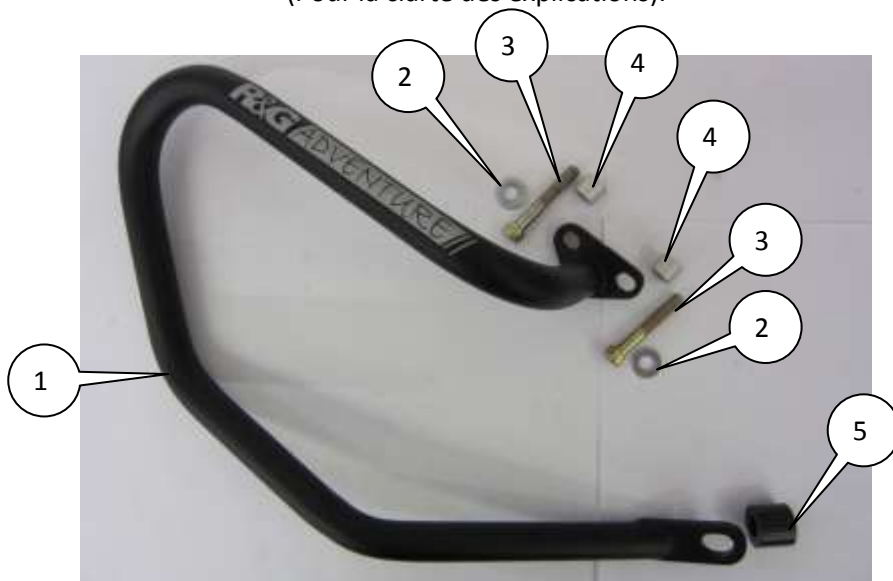

Coté gauche



Vérifier le contenu de la boîte avant de déballer les pièces. Ne pas procéder au montage s'en s'être assuré au préalable que les articles soient bien présents.



Coté droit

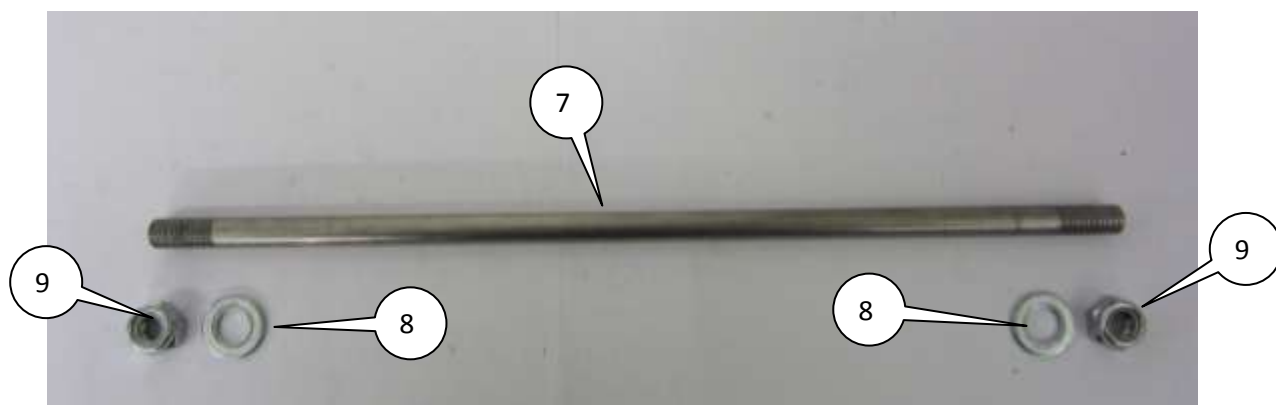

Articles additionnels



LEGENDE

Article 1 = Aventure Barre coté gauche (CB015) (x1).

Article 2 = Rondelles M8, 2 pour chaque coté (x4).

Article 3 = M8x1.25x50mm Longs boulons à tête ronde (Cotés supérieur gauche et droit) (x4).

Article 4 = Entretoises cotés supérieurs gauche et droit (12mm de long) (S0138) (x4).

Article 5 = Entretoises cotés inférieurs gauche et droit (21mm de long) (S0027) (x2).

Article 6 = Aventure Barre coté droit (CB016) (x1).

Article 7 = 12mm Barre moteur (380mm de long) (EB0006) (x1).

Article 8 = Rondelles M12 (coté gauche et droit) (x2).

Article 9 = M12 Erous en Nyloc (x2).

Outils requis

- Clefs: 2x 17 et 19mm
- Clef Allen 6mm
- Clef Dynamométrique (réglable à plus de 40Nm).



Photo 1



Instructions de montage

Coté gauche assis sur la moto:

- Enlever les boulons de fixation du cadre moteur (étiquette A et B en photo 1)
- Enlever le boulon moteur (C) en photo 1 (Vous devrez tenir l'écrou du coté droit).
- Placer 2 des boulons M8 (articles 3=50mm de long) avec les rondelles (articles 2) à travers la plaque de fixation supérieure du coté gauche de la barre Aventure (article 1) comme indiqué : A et B en photo 1.
- Placer 2 des plus petites entretoises (articles 4=12mm de long) autour de l'extrémité des boulons.
- Placer la barre Aventure en position comme indiqué en A (Ne pas serrer à ce stade).
- Placer une des rondelles M12 (article 8) et un des écrous M12 en Nyloc (article 9) sur la barre de moteur (article 7) en s'assurant que l'écrou soit pleinement engagé.
- Placer une des plus larges entretoises (article 5) dans le creux du cadre étiquette C sur le photo 1.
- Pousser la barre de moteur (article 7) avec écrou et rondelle à travers la plaque de fixation inférieure des barres Aventure et à travers l'entretoise inférieure (article 5, photo 1).
- Serrer les 2 boulons supérieurs à pas plus de 20Nm.





Photo 2

Coté droit assis sur la moto:

- Enlever les boulons de fixation du cadre moteur (étiquette D et E en photo 2)
- Placer l'entretoise inférieure restante (article 5) dans le creux de cadre et autour de l'extrémité de la barre de moteur (position F, photo 2).
- Placer les 2 boulons M8 restants (articles 3=50mm de long) avec rondelles (articles 2) à travers la plaque de montage supérieure du coté droit de la barre Aventure (article 6) (D et E en photo 2).
- Placer 2 des plus petites entretoises (articles 4=12mm de long) autour de l'extrémité des boulons.
- Placer la barre Aventure en position comme indiqué en photo 2 (Ne pas serrer à ce stade).
- Placer une des rondelles M12 (article 8) et un des écrous M12 (article 9) sur la barre de moteur (article 7) en s'assurant que l'écrou soit pleinement engagé.
- Serrer les 2 boulons supérieurs à pas plus de 20Nm.
- Serrer l'écrou M12 inférieur (Vous devrez tenir l'autre écrou M12 en Nyloc du coté gauche) à pas plus de 40Nm en vous assurant que les 2 écrous soient complètement engagés.

ISSUE 1 22/05/2012 (NSY)