

INSTALLATION INSTRUCTION

Model	Product	Code
HONDA Monkey 125	Headlights Grill	PLG-HM

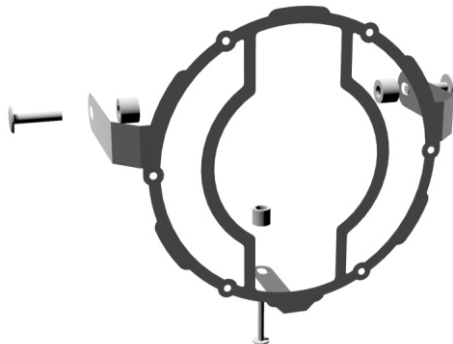

CONTENTS

1. 1pcs Metal parts (D2-PLG-HM)
2. 2pcs screws M6X30 allen oval
3. 1pc screws M4X30 allen oval
4. 6 screws M4X12 allen oval
5. 6pcs M4 nuts with washer
6. 2pcs adapters $\Phi 16 \times \Phi 8 \times 12$ mm
7. 1pcs screws M4X30 allen oval
8. 3pcs plexi (PL-4)

MATERIAL DESCRIPTION

The product is made of metal DKP 2mm thickness painted black with electrostatic paint.
The membrane is made of plexiglass.
The screws, nuts, washers and all the rest required for the installation are galvanized in silver color.



These are the contents you will find inside product packaging. Also in the package you will find a card containing the link to download the PDF file with the installation instructions detailed step-by-step with photographic material.

Before starting the installation, read the instructions to have a better idea about the tools you will need and the required skills. Otherwise we suggest to contact a professional.

The product is for race use only

For any further information please do not hesitate to contact us: Tel.: +30 2108075387 Email: info@c-racer.com



Choose the color you want, remove the protective film and screw it to the back of grill.



Remove the lower headlight screw adjusting the height of the light.



Remove the screws on the sides that hold the light.



Place the large adapters on the inside side of the light base and pass the grill over it.



Pass the screw and mount without tightening it.
Do the same on the other side.



Screw the bottom screw as well, putting the small
adapter between as shown in the photo.
Adjust the position you want and tighten all the screws



This will be your final result. Enjoy your rides!