



**MODEL** BMW R NINE T

**YEAR** 2014 -->

**LINE** SPORT

**MUFFLER** X-CONE PLUS

**SCHEMATIC**

**ELENCO PARTI / PARTS LIST**

#	QTÀ / QTY	DESCRIZIONE / DESCRIPTION	CODICE / CODE
1	1	Fascetta Ø 64/67 mm / Pipe clamp Ø 64/67 mm	50.FA.011.1
2	1	Tubo di raccordo / Link pipe	9773B02457
3	1	Tubo di raccordo 2-1 / Link pipe 2-1	9773B0245C1
4	3	Dado M8 flangiato / Flanged nut M8	50.73.393.1
5	2	Boccola / Bush	50.73.381.1
6	2	Silentblock / Silentblock	50.73.380.1
7	1	Staffa / Bracket	50.SS.865.0
8	2	Vite M8 x 16 / Screw M8 x 16	50.73.098.1
9	1	Rondella alluminio / Aluminium washer	50.73.291.1
10	1	Vite M8x40 / Screw M8x40	50.73.075.1
11	2	Dado rapido M5 / M5 Cage nut	50.73.674.1
12	2	Rondella / Washer	50.62.127.0
13	2	Vite M5 x 8 / Screw M5 x 8	50.73.459.1
14	1	Cover in carbonio / Carbon cover	50.CR.020.0
15	1	Molla media / Middle spring	50.73.359.1
16	1	Tubo in gomma per molla / Rubber pipe for spring	50.73.210.1
17	2	Silenziatore / Muffler	X-CONE PLUS
18	2	DB killer / DB killer	50.DK.033.0
19	2	Anello Seger / Seger ring	50.73.218.1
20	1	Staffa / Bracket	50.SS.864.0

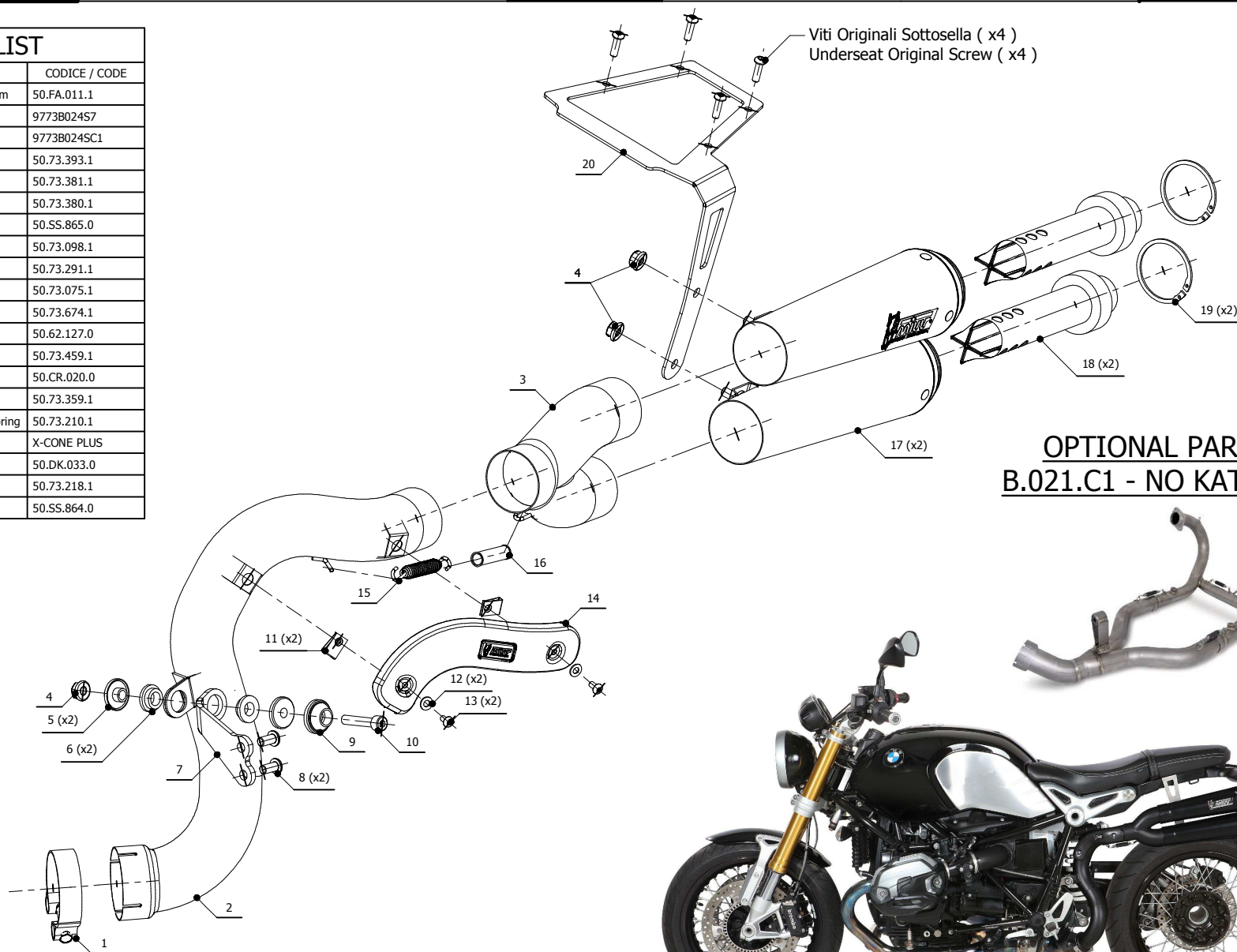

Viti Originali Sottosella ( x4 )  
Underseat Original Screw ( x4 )

**OPTIONAL PARTS**  
**B.021.C1 - NO KAT PIPE**

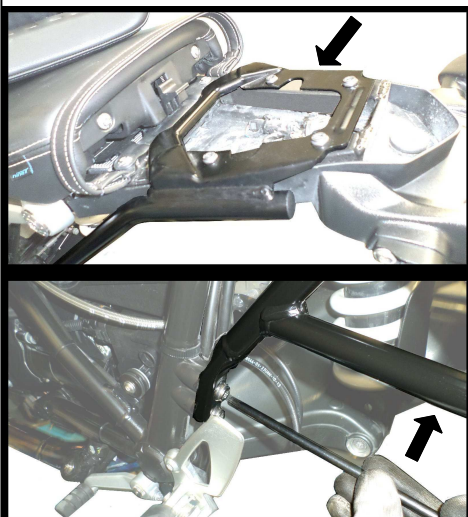

Il telaio pedana passeggero originale deve essere rimosso e sostituito dalla staffa sottosella MIVV (#20)

The original passenger footrest frame must be removed and replaced by the MIVV underseat bracket (#20)



**APPLICAZIONI / APPLICATIONS**

CODICE / CODE	TUBO / PIPE	SILENZIATORE / MUFFLER	CODICE OMOL. / HOMOL. CODE
B.024.LP1	INOX / ST. STEEL	INOX / ST. STEEL	ME008 e9 1176