



**MODEL** HONDA CBR 250 R

**YEAR** 2011 - 2014

**LINE** SLIP ON

**MUFFLER** GP

**SCHEMATIC**

**ELENCO PARTI / PARTS LIST**

#	QTÀ / QTY	DESCRIZIONE / DESCRIPTION	CODICE / CODE
1	1	DB killer / DB killer	50.DK.021.0
2	1	Silenziatore / Muffler	GP
3	1	Protezione in gomma per staffa / Rubber protection for bracket	50.73.040.1
4	1	Staffa / Bracket	50.SS.001.0
5	1	Db Killer forato / Drilled DB killer	50.DK.082.0
6	1	Tubo di raccordo / Link pipe	9773H047S2
7	1	Guarnizione in grafite / Graphite bush	50.72.38.44.28
8	1	Fascetta Ø 44/47 mm / Pipe clamp Ø 44/47 mm	50.FA.006.1
9	1	Vite M8x50 / Screw M8x50	50.73.074.1
10	1	Rondella in alluminio / Aluminium washer	50.73.063.1
11	2	Boccola / Bush	50.73.381.1
12	1	Dado M8 flangiato / Flanged nut M8	50.73.393.1
13	1	Molla media / Middle spring	50.73.359.1
14	1	Tubo in gomma per molla / Rubber pipe for spring	50.73.210.1

**Catalytic Converter  
Cod. ACC.037.A1**

*Optional for H.047.L2S - H.047.L6S - H.047.LXB  
Included in H.047.K2S - H.047.K6S - H.047.KXB*

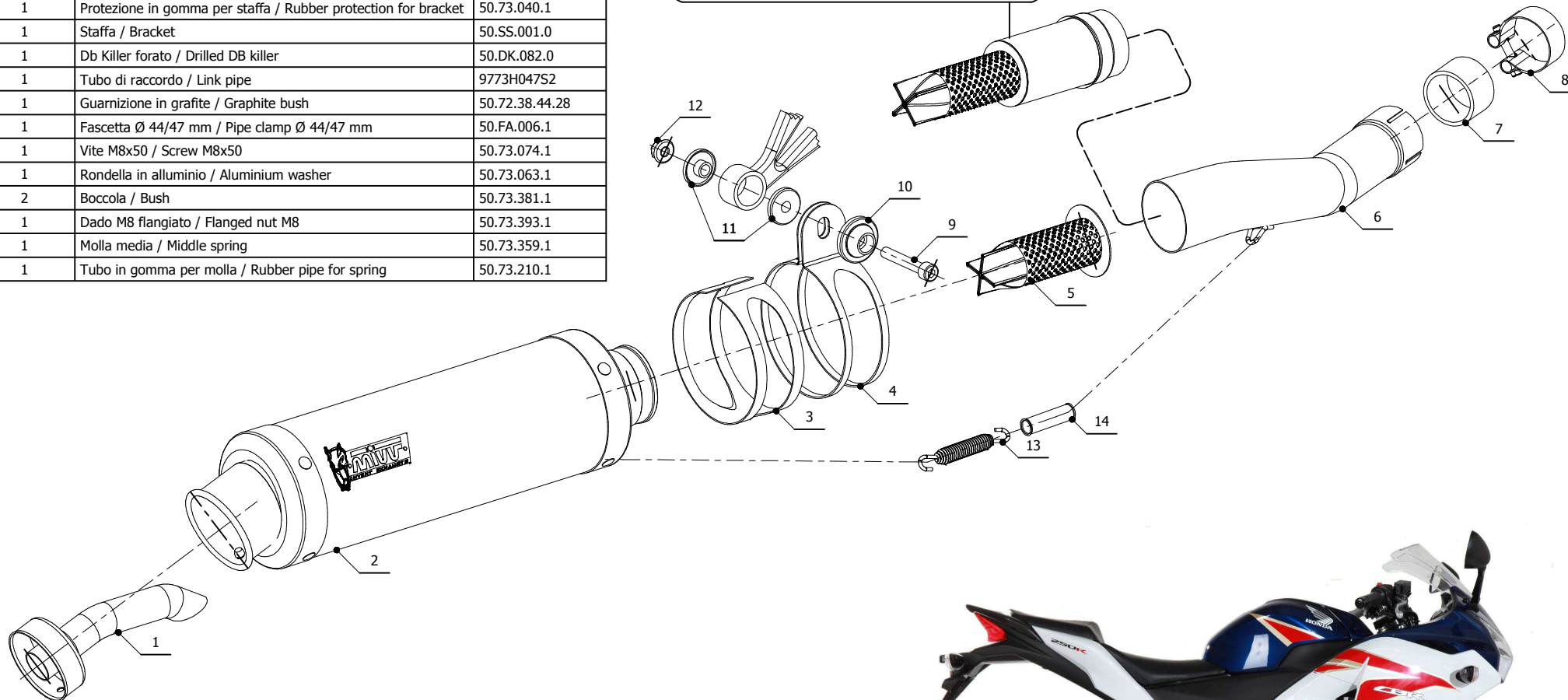

**APPLICAZIONI / APPLICATIONS**

CODICE / CODE	SILENZIATORE / MUFFLER	TUBO / PIPE	FASCETTA / CLAMP	NOTE
H.047.L2S H.047.L6S H.047.LXB	CARBONIO / CARBON FIBER TITANIO / TITANIUM STEEL BLACK	INOX / ST. STEEL	INOX / ST. STEEL	CATALYTIC CONVERTER NOT INCLUDED
H.047.K2S H.047.K6S H.047.KXB	CARBONIO / CARBON FIBER TITANIO / TITANIUM STEEL BLACK	INOX / ST. STEEL	INOX / ST. STEEL	CATALYTIC CONVERTER INCLUDED

