

INSTALLATION INSTRUCTION

Model	Product	Code
HONDA Monkey 125	Chain Guard in Silver & black color	CG-HM-S & CG-HM-B

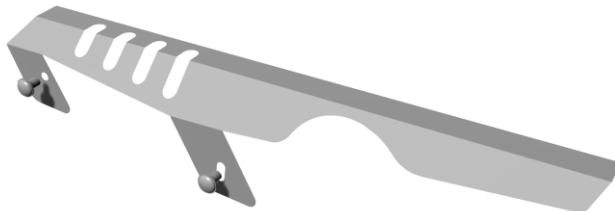

CONTENTS

1. 1pcs Aluminum Metal Base(CG-HM)
2. 2pcs M6X10 allen oval screws
3. 2pcs washers 6X18 plastic

MATERIAL DESCRIPTION

The product is made of aluminum 3 mm thick and painted in black or silver color, with electrostatic paint. (CG-HM-S silver color & CG-HM-B black color). The screws, nuts, washers and all the rest required for the installation are galvanized in silver color.



These are the contents you will find inside product packaging. Also in the package you will find a card containing the link to download the PDF file with the installation instructions with detailed step-by-step and photographic material.

Before starting the installation, read the instructions to have a better image about the tools you have and the skills required. Otherwise we suggest to contact a professional.

The product is for race use only

For any further information please do not hesitate to contact us: Tel.: +30 2108075387 Email: info@c-racer.com

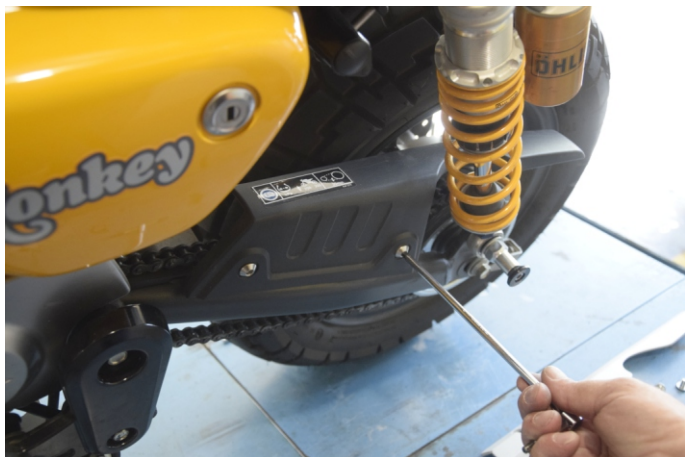

Remove the two screws holding the old chain guard and remove it from the motorcycle.



Place the new guard in the same position as old one. Screw it in with the new screws provided in the package. You can adjust the back of the protector vertically and finally tighten it well.



This will be your final result. Enjoy your ride!