



FITTING INSTRUCTIONS FOR BP0013BK
HEATSINK GUARD / BASH PLATE
ZERO FX, FXS, MMX 2019-



THIS KIT CONTAINS THE ITEMS PICTURED AND LABELLED OVER PAGE.

SOME PARTS MAY BE SHOWN FOR CLARITY OF INSTRUCTIONS ONLY.

DO NOT PROCEED UNTIL YOU ARE SURE ALL PARTS ARE PRESENT.

PLEASE READ ALL INSTRUCTIONS BEFORE PROCEEDING.

**IF IN ANY DOUBT WHEN FITTING OUR PRODUCTS, CONSULT ONE OF OUR DEALERS
OR HAVE FITTED BY A QUALIFIED TECHNICIAN.**

PLEASE NOTE THAT THE WAY THE KIT IS PACKED DOES NOT NECESSARILY REPRESENT THE WAY OF
MOUNTING TO THE BIKE.

IN THE EVENT OF RUBBER WASHERS BEING USED TO HOLD COMPONENTS ONTO BOLTS,
THESE RUBBER WASHERS CAN BE THROWN AWAY.

DIGITAL COPIES OF THESE INSTRUCTIONS ARE AVAILABLE FROM:

WWW.RG-RACING.COM

R&G Racing
Unit 1, Shelley's Lane, East Worldham, Alton, Hampshire, GU34 3AQ
Tel: +44 (0)1420 89007 Fax: +44 (0)1420 87301 www.rg-racing.com Email: info@rg-racing.com



<u>TOOLS REQUIRED</u>	<u>GENERAL TORQUE SETTINGS</u>
<ul style="list-style-type: none"> • 4mm A/F ALLEN TOOL • 10mm A/F SOCKET AND WRENCH 	<p>M4 BOLT = 8Nm</p> <p>M5 BOLT = 12Nm</p> <p>M6 BOLT = 15Nm</p> <p>M8 BOLT = 20Nm</p> <p>M10 BOLT = 40Nm</p> <p>M12 BOLT = 40Nm</p>

LEGEND

ITEM NO.	DESCRIPTION	QTY
ITEM 1	SMW0173 BASH PLATE	1
ITEM 2	S0697 HEATSINK SPACERS	2
ITEM 3	M6 x 1.00 x 65mm BUTTON HEAD BOLTS (HEATSINK)	2
ITEM 4	M6 x 1.00 x 25mm BUTTON HEAD BOLTS (UNDERSIDE)	3
ITEM 5	M6 x 1.00 x 16mm BUTTON HEAD BOLTS (SIDE)	2
ITEM 6	M6 WASHERS OD=19mm (HEATSINK)	2
ITEM 7	M6 WASHERS OD=13.8mm	5
ITEM 8	100mm LENGTHS OF SELF-ADHESIVE NEOPRENE FOAM	5



EXPLODED ASSEMBLY

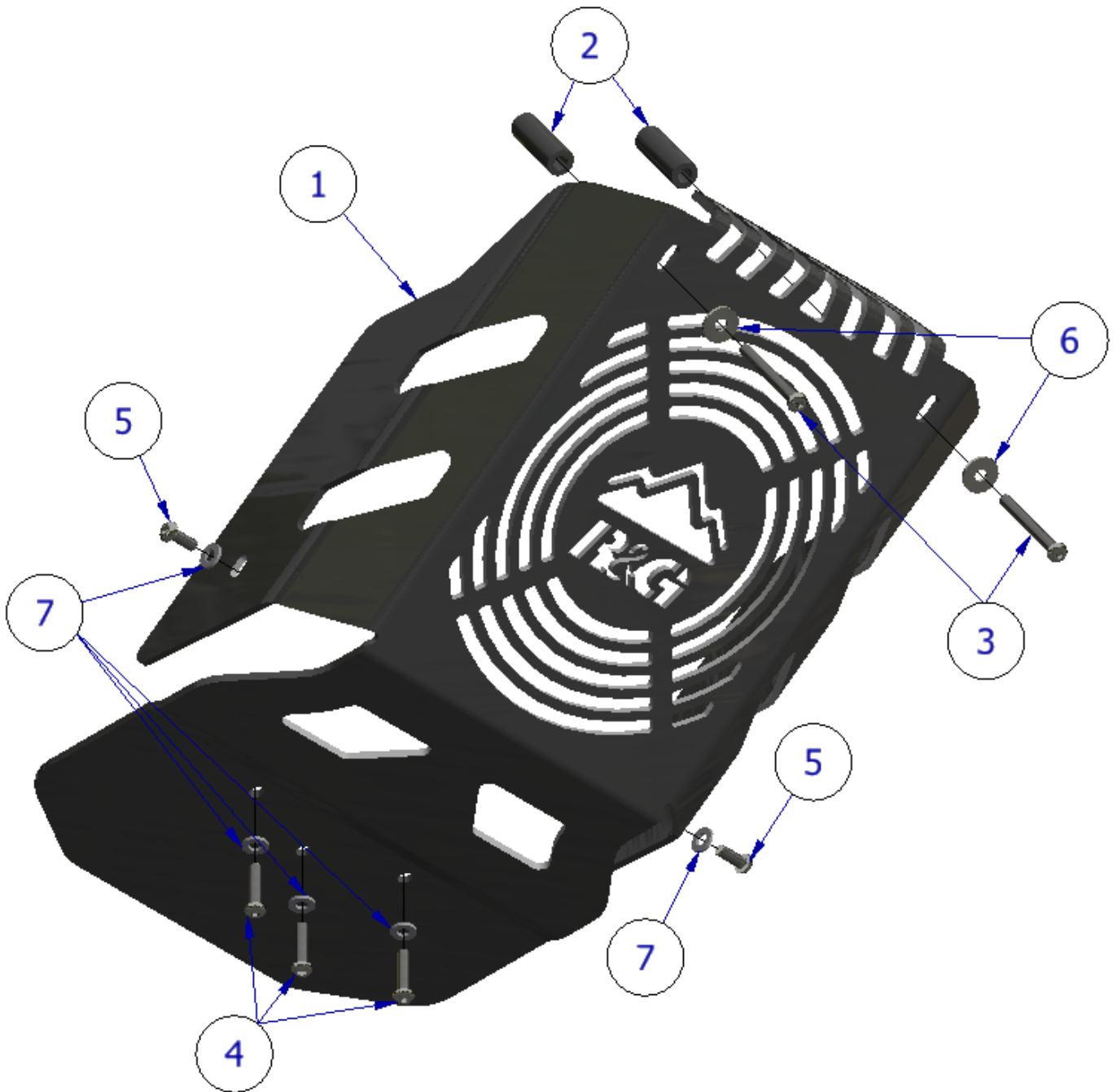



FITTING PICTURES



Picture 1



Picture 2

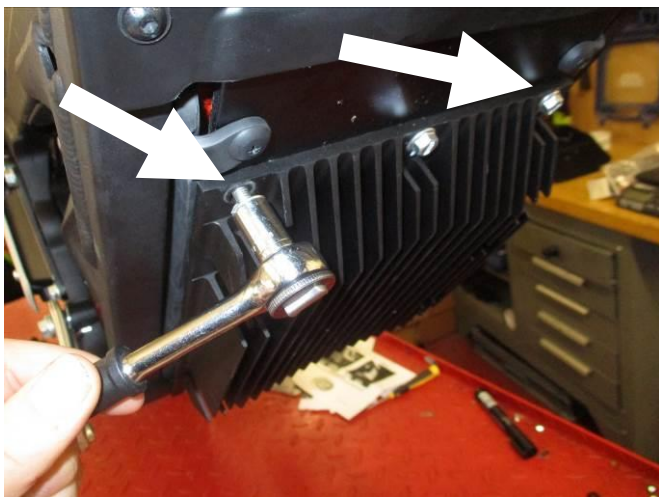

Picture 3



Picture 4



Picture 5



Picture 6



FITTING INSTRUCTIONS

- To fit the R&G bash plate, the original plate will need to be removed. Using a 10mm socket and wrench, remove the 3x underside bolts and the 2x side mounting bolts, as shown in pictures 1 and 2.
- Remove the 2x heatsink securing bolts shown in picture 3, using a 10mm socket and wrench.
- Fit the included self-adhesive foam (**item 8**) to the inner contact areas of the new bash plate (**item 1**) to protect the frame from paint damage.
- Offer the bash plate up to the bike and using a 4mm Allen tool, loosely secure with the new 3x 25mm underside M6 button head bolts (**item 4**) and washers (**item 7**), as shown in picture 4.
- Loosely secure the side mounts with the new 2x 16mm M6 button head bolts (**item 5**) and washers (**item 7**), as shown in picture 5.
- Place the spacers (**item 2**) between the heatsink and the bash plate and secure with the new 2x 65mm M6 button head bolts (**item 3**) and larger washers (**item 6**).
- Fully tighten all bolts.

ISSUE 1 – 20/11/2020 (FB)

CONSUMER NOTICE

The catalogue description and any exhibition of samples are only broad indications of the Products and R&G may make design changes which do not diminish their performance or visual appeal and supplying them in such state shall conform to the order. The Buyer acknowledges no representation or warranty (other than as to title) has been given or will apply to the Products other than those in R&G's order or confirmation and the Buyer confirms it has chosen the Products as being of merchantable quality and suitable for its particular purposes. Where R&G fits the Products or undertakes other services it shall exercise reasonable skill and care and rectify any fault free of charge unless the workmanship has been disturbed. The Buyer is responsible for ensuring that the warranty on the motorcycle is not affected by the fitting of the Products. On return of any defective Products R&G shall at its option either supply a replacement or refund the purchase money but shall not be liable if the Products have been modified or used or maintained otherwise than in accordance with R&G's or manufacturer's instructions and good engineering practice or if the defect arises from accident or neglect. Other than identified above and subject to R&G not limiting its liability for causing death and personal injury, it shall not be liable for indirect or consequential loss and otherwise its liability shall be limited to the amounts paid by the Buyer for the Products or the fitting or service concerned. These terms do not affect the Buyer's statutory rights.

R&G RACING RETURNS POLICY (NON-FAULTY GOODS)

Returns must be pre-authorized (if not pre-authorized the return will be rejected). Goods may only be returned direct to us if they were purchased direct from us (customer must prove if necessary). Otherwise to be returned to original vendor. Goods must be in re-sellable condition, in the opinion of R&G Racing. All returns are subject to a 25% restocking and handling fee (25% of the gross value exc. P&P – at the prevailing price at time of purchase). The customer must pay any and all carriage charges. No returns of discontinued products, unless within 14 days of purchase. This policy does not affect your statutory rights and does not refer to faulty goods.

R&G Racing

Unit 1, Shelley's Lane, East Worldham, Alton, Hampshire, GU34 3AQ

Tel: +44 (0)1420 89007 Fax: +44 (0)1420 87301 www.rg-racing.com Email: info@rg-racing.com



NOTICE DE MONTAGE POUR BP0013BK
PROTECTION DISSIPATEUR DE CHALEUR / PROTECTION CHOCS
ZERO FX, FXS, MMX 2019-



CE KIT CONTIENT LES ARTICLES ILLUSTRÉS ET ÉTIQUETES SUR LA PAGE.
CERTAINES PARTIES PEUVENT ÊTRE PRÉSENTES UNIQUEMENT POUR LA CLARTÉ DES INSTRUCTIONS.

NE PAS PROCÉDER AU MONTAGE TANT QUE VOUS N'ÊTES PAS SÛR QUE TOUTES LES PIÈCES SOIENT PRÉSENTES.

VEUILLEZ LIRE TOUTES LES INSTRUCTIONS AVANT DE CONTINUER.

EN CAS DE DOUTE LORS DU MONTAGE DE NOS PRODUITS, CONSULTEZ UN DE NOS REVENDEURS OU FAITES APPEL À UN TECHNICIEN QUALIFIÉ.

VEUILLEZ NOTER QUE LA FAÇON DONT LE KIT EST EMBALLÉ NE REPRÉSENTE PAS NECESSAIREMENT LA MANIÈRE DE LE MONTER SUR LA MOTO.

SI DES RONDELLES EN CAOUTCHOUC SONT UTILISÉES POUR MAINTENIR LES COMPOSANTS SUR LES BOULONS, ELLES PEUVENT ÊTRE JETÉES.

NOTICE DISPONIBLE AU TÉLÉCHARGEMENT SUR :

WWW.RG-RACING.COM

R&G Racing

Unit 1, Shelley's Lane, East Worldham, Alton, Hampshire, GU34 3AQ

Tel: +44 (0)1420 89007 Fax: +44 (0)1420 87301 www.rg-racing.com Email: info@rg-racing.com



<u>OUTILS REQUIS</u>	<u>VALEURS DE SERRAGE</u>
<ul style="list-style-type: none"> • CLÉ ALLEN 4mm • CLÉ À CLIQUET + DOUILLE 10mm 	M4 BOULON = 8Nm M5 BOULON = 12Nm M6 BOULON = 15Nm M8 BOULON = 20Nm M10 BOULON = 40Nm M12 BOULON = 40Nm

LÉGENDE

ARTICLE NO.	DESCRIPTION	QTÉ
ARTICLE 1	SMW0173 PROTECTION CHOCS	1
ARTICLE 2	S0697 ENTRETOISES DE DISSIPATEUR DE CHALEUR	2
ARTICLE 3	M6 x 1.00 x 65mm BOULONS (DISSIPATEUR DE CHALEUR)	2
ARTICLE 4	M6 x 1.00 x 25mm BOULONS (EN DESSOUS)	3
ARTICLE 5	M6 x 1.00 x 16mm BOULONS (CÔTÉ)	2
ARTICLE 6	M6 WASHERS OD=19mm (DISSIPATEUR DE CHALEUR)	2
ARTICLE 7	M6 RONDELLES = 13.8mm	5
ARTICLE 8	100mm LONGUEURS DE MOUSSE NEOPRENE AUTOCOLLANTES	5



Schéma d'ensemble

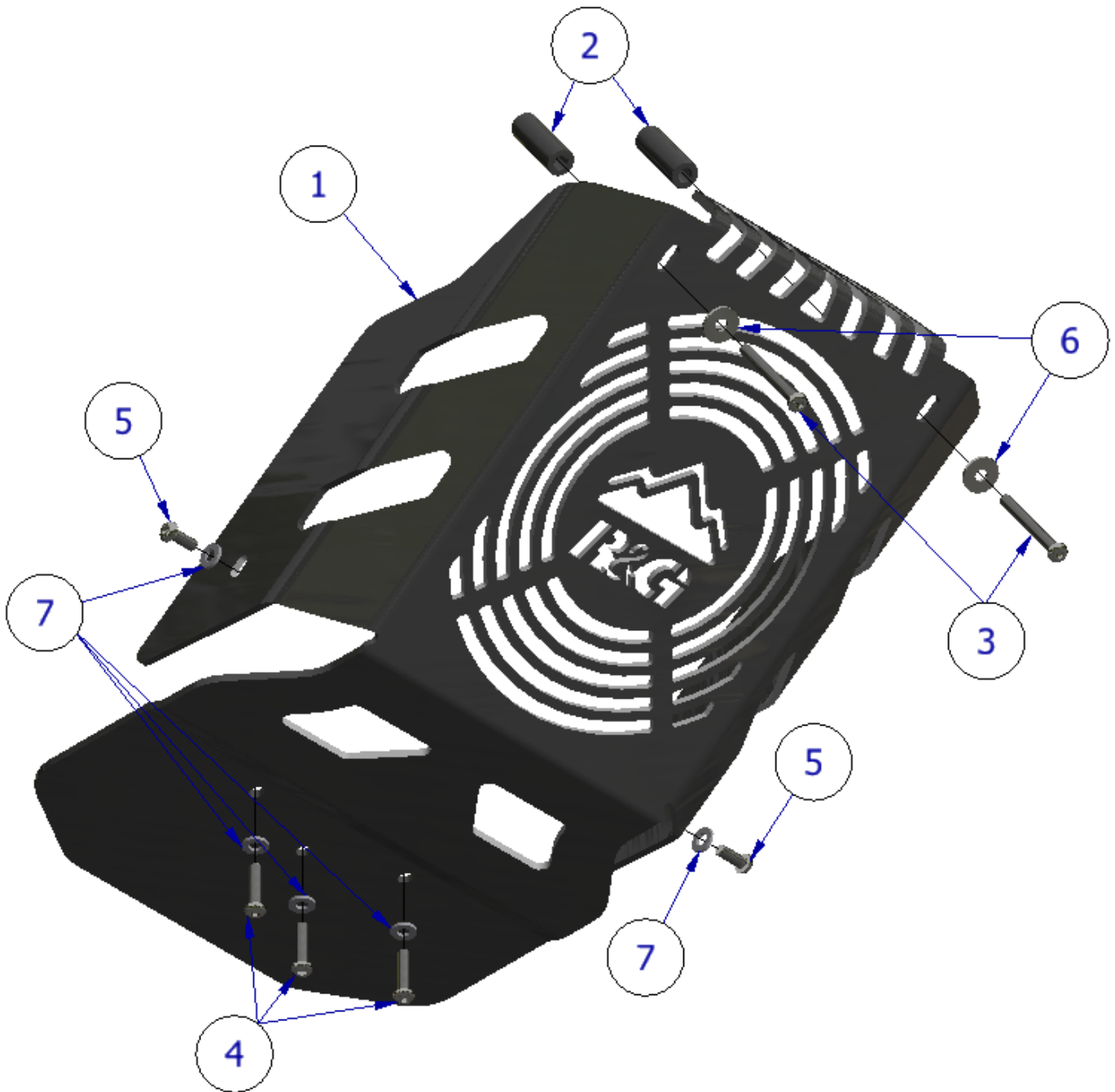



NOTICE DE MONTAGE

- Pour installer la plaque de protection R&G, la plaque d'origine devra être retirée. À l'aide d'une douille de 10 mm et d'une clé, retirez les 3 boulons inférieurs et les 2 boulons de montage latéraux, comme indiqué sur les photos 1 et 2.
- Retirez les 2x boulons de fixation du radiateur illustrés sur la photo 3, à l'aide d'une douille de 10 mm et d'une clé.
- Installez la mousse autocollante incluse (article 8) sur les zones de contact intérieures de la nouvelle plaque de (article 1) pour protéger le cadre contre les dommages de peinture.
- Présetez la plaque sur la moto et à l'aide d'une clé Allen de 4 mm, fixez-la sans serrer avec les nouveaux boulons à tête ronde M6 3x 25 mm (article 4) et rondelles (article 7), comme indiqué sur la photo 4.
- Fixez sans serrer les supports latéraux avec les nouveaux boulons à tête ronde 2x 16 mm M6 (article 5) et rondelles (article 7), comme indiqué sur la photo 5.
- Placez les entretoises (article 2) entre le dissipateur thermique et la plaque et fixez-les avec les nouveaux boulons à tête ronde 2x 65 mm M6 (article 3) et les rondelles plus grandes (article 6).
- Serrez complètement tous les boulons

ISSUE 1 – 20/11/2020 (FB)