



## Fitting Instruction

Article-No. : **110B025 & 110B025T**  
Product : **Rear Set**  
Manufacturer : **BMW**  
Model : **R 1100S w/o ABS**

### Important:

Read this instruction manual carefully and mind all warnings and tips. You should do this work only if you're qualified; otherwise we recommend this mounting to be done by a qualified workshop. Improperly mounting of this kit can reduce the driveability of the motorcycle and may be a risk to your health and life.

Special works are marked with the following signs. Please take special care on these works.



**Warning! Important mounting instruction. It shows risks to your life and health.**



**Tips for mounting and maintenance or to avoid damage.**

### Fitting:

Remove stock rear sets. The following original parts will be used for your new rear set: gearbox lever, left and right heel protector.



**Rear sets are pre-assembled but all screws are not tightened!** Always use locknuts or proper amount of medium thread-locking adhesive (e. g. Loctite 243). All details of assembling are shown on the backside drawing. All parts are welded into their bags as they belong together.

The tightening torques for connections to the frame refers to the manufacturers' instructions. Use the following torques for all the other screwing:

<b>M5</b>	<b>=</b>	<b>6Nm</b>
<b>M6</b>	<b>=</b>	<b>10Nm</b>
<b>M8</b>	<b>=</b>	<b>20Nm</b>
<b>M10</b>	<b>=</b>	<b>30Nm</b>



**A flexible brake-hose is useful.** A brake-hose with 410mm length and fittings with 20° and 90° is required (LSL Article No.: 225BS41BD).



After installing your new rear set **test brake and gear shifting at low speed. If anything is not operating properly or braking efficiency is poor, testing at high speeds may result in death or serious injury!**

### Maintenance:



Periodically proof all functions during service intervals. Use **particle free (no MoS<sub>2</sub>)** lithium or barium soap grease to maintain lever bushings.

Master brake cylinder

Mount ball joint instead of the original fork at the push rod. To reach a deep lever position it may be necessary to shorten the push rod

Screw in M6 x 25 from lever outside and attach spacer (t=2mm) and ball joint to the inside with locknut M6

Mount brake lever as shown in separate drawing for peg adapter

Adjust brake lever position with the original stop screw and its counternut

Screw in M6 x 18 from outside and attach bushing (t=3mm) and spring bracket bolt to the inside

Mount original heel protector from outside and attach brake cylinder to the inside with screws M6 x 18

Fix spring with short spring bracket bolt (l=16mm)

Mount stay with 2x M8 x 20 on your individual position

New brake lever spring

Brake Lever

Fix brake lever knob with countersunk M6 x16

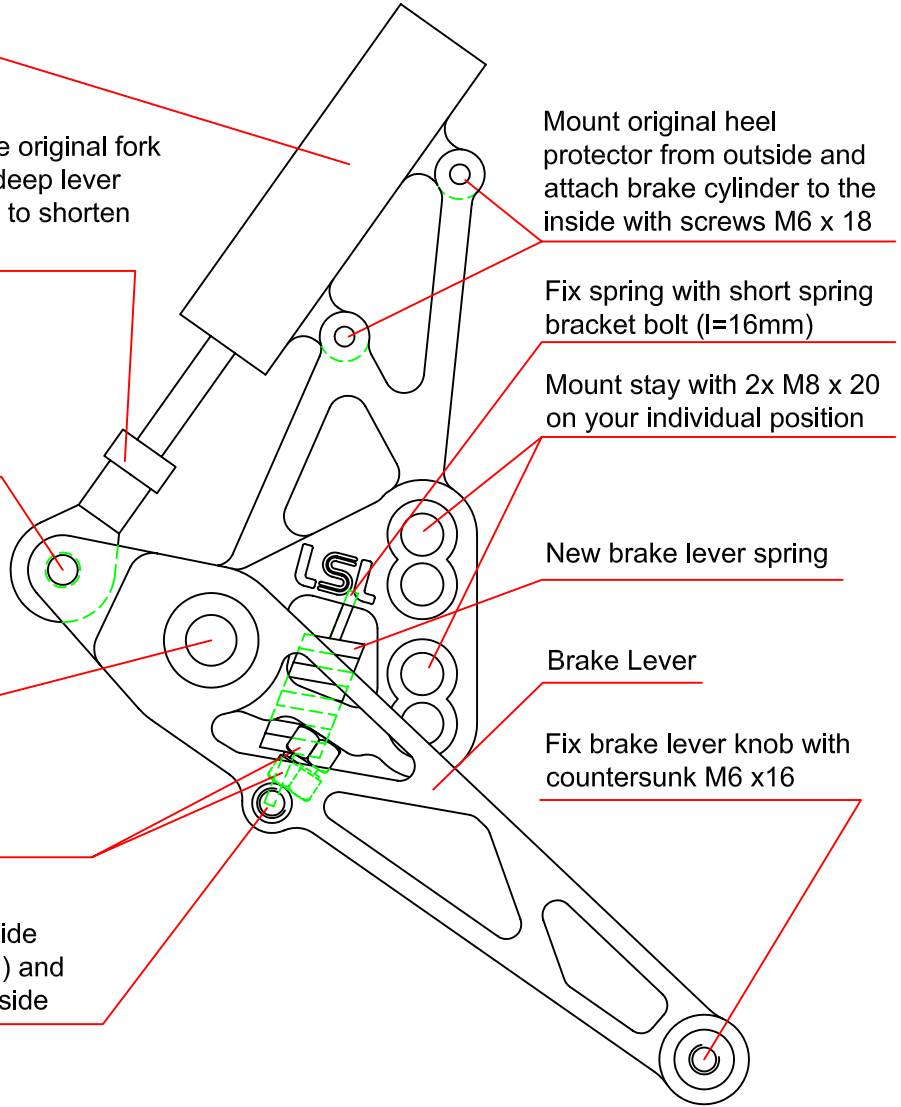

Fix the original heel protector with M5 x 10 at the outside of stay

Mount stay with 2x M8 x 20 on your individual position

Mount ball joint with M6 x 40 and bushing (t=18mm) at the gearbox lever

Counternut M6

Fix gearshift lever knob with countersunk M6 x16

Mount countersunk screw M6 x 45 from the outside, attach bushing (t=20mm) and ball joint to the inside and fix it with locknut M6

Gearshift lever

Mount gearshift lever as shown in separate drawing for peg adapter

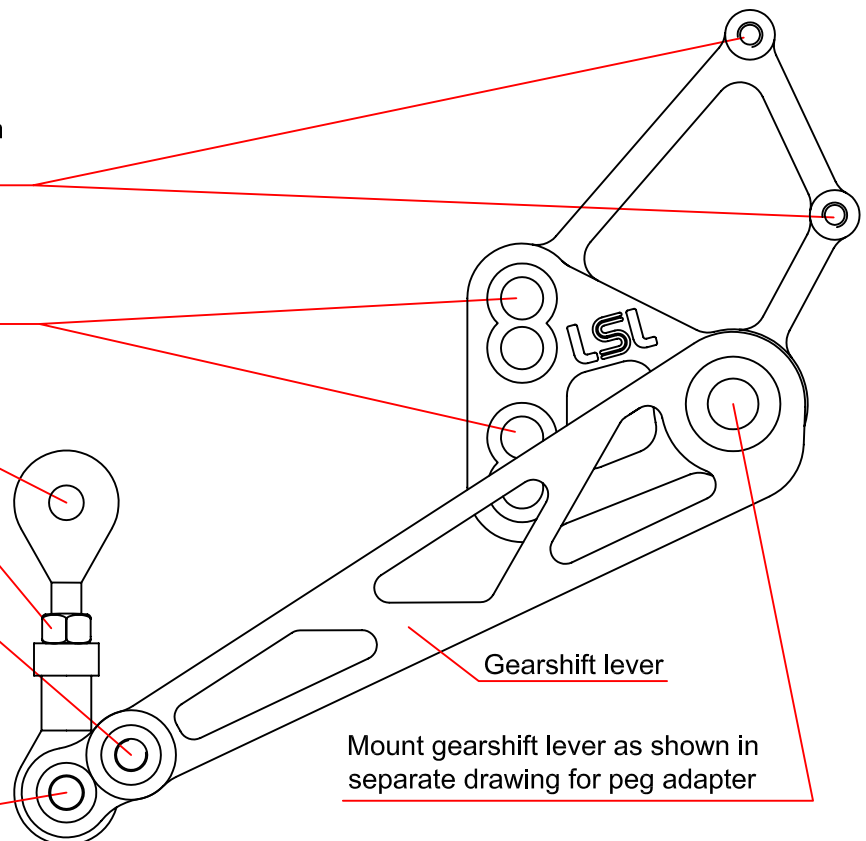

ULS M10x1.25x25

Schraubensicherung  
mittelfest  
z.B.: Loctite 243

medium thread  
locking adhesive  
e.g. Loctite 243

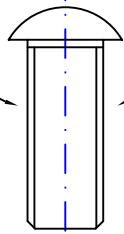

Grundplatte

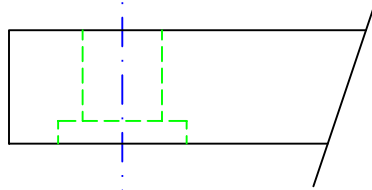

Stay

Paßscheibe verwenden,  
falls Hebel nicht  
beweglich

If lever is blocked use  
shim ring



Scheibe Ø25mm



Washer Ø25mm

Brems/ Schalthebel

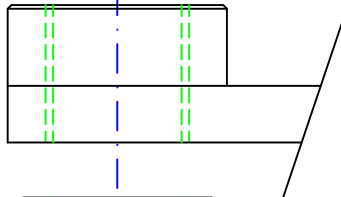

Brake pedal/ Shifter

Scheibe Ø25mm



Washer Ø25mm

Fett

Grease

Klappbare/  
starre Lagerung

Peg adapter / journal

