



## Fitting Instruction

Part-No. : **118S114**  
Product : **Rear Set**  
Vehicle Manufacturer : **Suzuki**  
Model : **GSX-R 1000 2007 - 2008**

### Important:

Read this instruction manual carefully and mind all warnings and tips. You should do this work only if you're qualified; otherwise we recommend this mounting to be done by a qualified workshop. Improperly mounting of this kit can reduce the driveability of the motorcycle and may be a risk to your health and life.

Special works are marked with the following signs. Please take special care on these works.



**Warning! Important mounting instruction. It shows risks to your life and health.**



**Tips for mounting and maintenance or to avoid damage.**

### Fitting:

Remove stock rear sets. The following parts will be used for your new rear set: Gearbox lever, right heel protector and bolts to fix the brake cylinder.



**Rear sets are pre-assembled but all screws are not tightened!** Always use locknuts or proper amount of medium thread-locking adhesive (e. g. Loctite 243). All details of assembling are shown on the backside drawing. All parts are welded into their bags as they belong together.



The original brake light switch has to be replaced by a hydraulic one. It replaces the banjo bolt that fixes the brake hose on the brake cylinder. **This is the highest point in the brake-system, proof proper air free installation! Use only seal rings according to the brake hose manufactures' instructions.**

The tightening torques for connections to the frame refers to the manufacturer's instructions. Use the following torques for all the other bolted connections:

<b>M5</b>	<b>=</b>	<b>6Nm</b>	<b>=</b>	<b>4.43lbf ft</b>
<b>M6</b>	<b>=</b>	<b>10Nm</b>	<b>=</b>	<b>7.38lbf ft</b>
<b>M8</b>	<b>=</b>	<b>20Nm</b>	<b>=</b>	<b>14.75lbf ft</b>
<b>M10x1,25</b>	<b>=</b>	<b>30Nm</b>	<b>=</b>	<b>22.13lbf ft</b>



After installing rear set, **test brake and gear shifting indoor. If anything is not operating properly or braking efficiency is poor, testing on the road may result in death or serious injury!**

### Maintenance:



Periodically proof all functions during service intervals. Use **particle free (no MoS<sub>2</sub>)** lithium or barium soap grease to maintain lever bushings.

**Advice:**

The position of the reservoir depends on the individual position: The new bracket is necessary to prevent the hose from crushing if backward positions are used

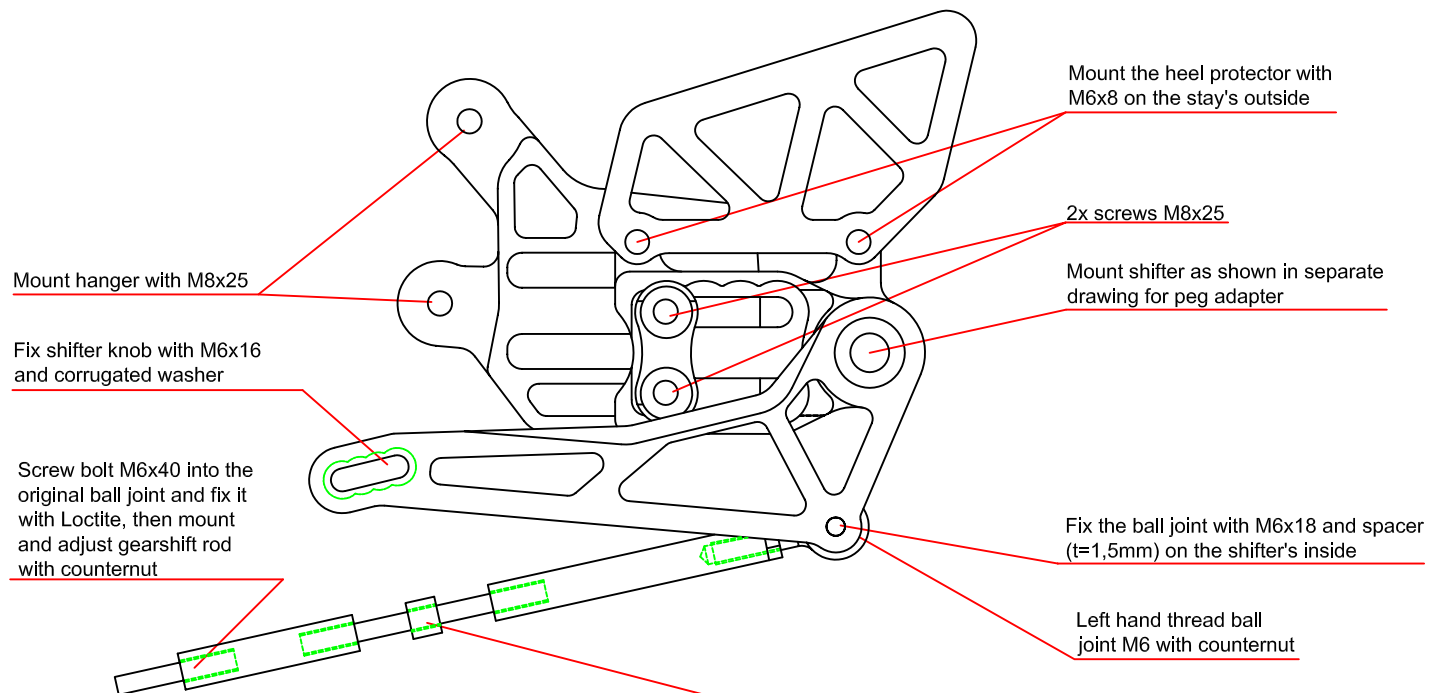
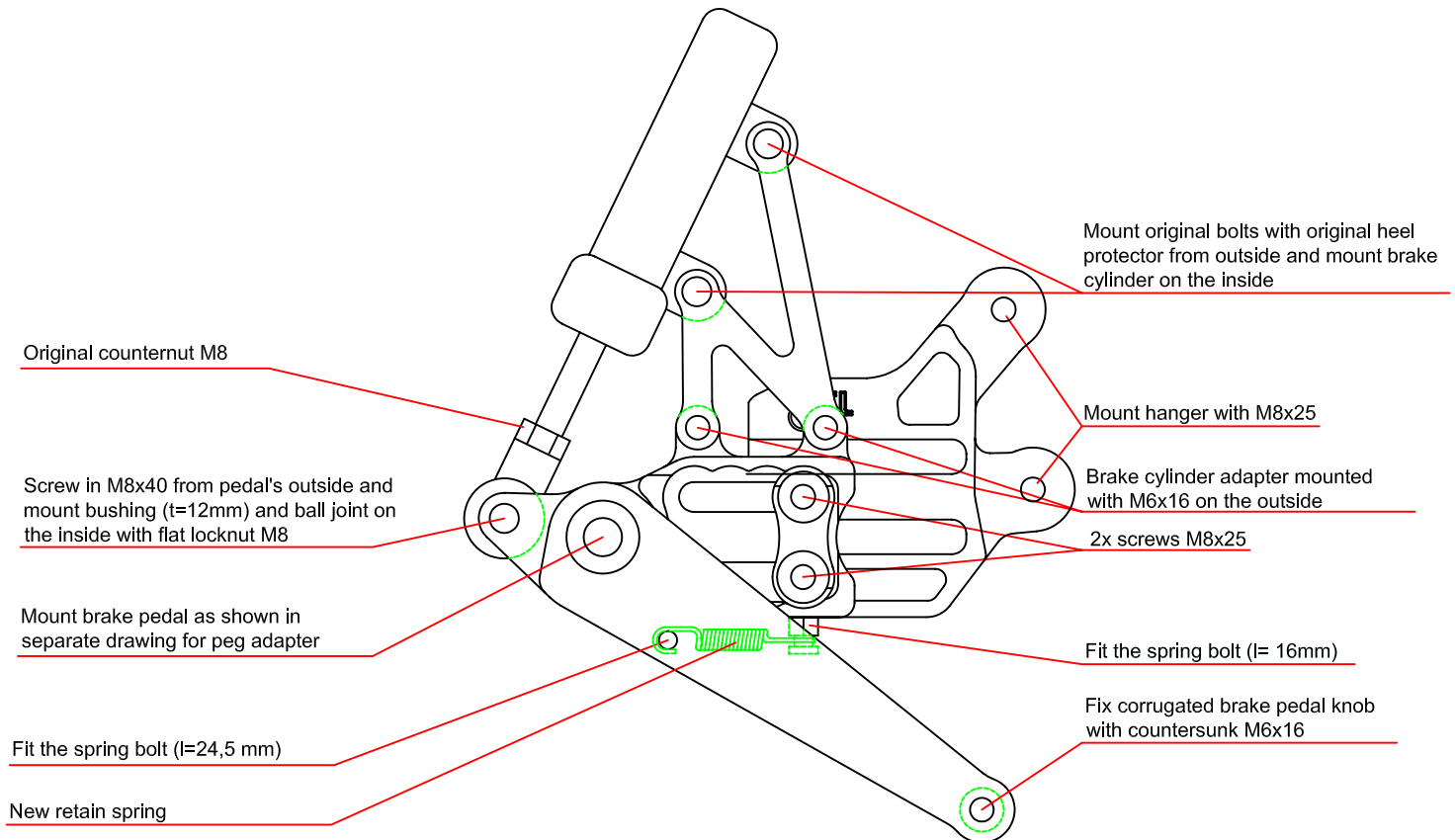
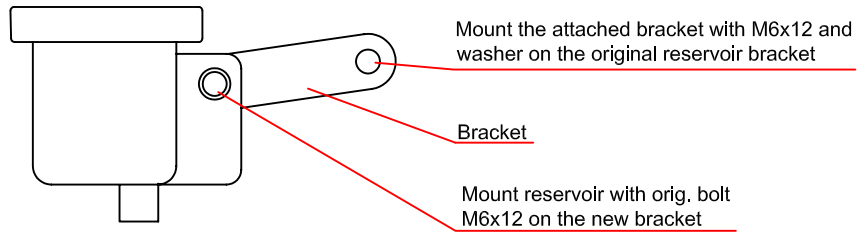

**Advice:** Loosen the gearbox lever's clamping bolt a few turns, pull the lever as far as possible outward and tighten it again.

Use the attached spacers 1 x 20mm and 1 x 10mm for your individual position

ULS M10x1.25x25

Schrauben-  
sicherung  
mittelfest  
z.B.: Loctite 243

prod. blocage  
de sécurité  
p.ex. Loctite 243

medium thread  
locking adhesive  
e.g. Loctite 243

Grundplatte

Plaque de fixation  
Hanger

ggf. Paßscheibe verwenden  
falls Hebel nicht beweglich

Utilisez rondelle de calage si  
le levier n'est pas mobile  
If lever is blocked use  
shim ring

Scheibe Ø28mm

Rondelle / Washer Ø28mm

Brems- / Schalthebel

Sélecteur/pédale frein  
Brake pedal/ Shifter

Scheibe Ø25mm

Rondelle / Washer Ø25mm

Fett

Graisse / Grease

starre Lagerung

Axe de fixation  
Journal

Fußraste

Footpeg

Support de pieds

Schrauben-  
sicherung  
mittelfest  
z.B.: Loctite 243

prod. blocage  
de sécurité  
p.ex. Loctite 243

medium thread  
locking adhesive  
e.g. Loctite 243

M5x25