



Anbauanleitung
Fitting Instruction
Notice de Montage

Artikel-Nr. / Article-No. / N° article : **100...**

Produkt / Product / Produit : **Gehäuseschelle / Body Clamp / Collier pour amortisseur de direction**



Achtung! Wichtiger Montage-Hinweis. Bei Nichtbeachtung können Gesundheit und Leben gefährdet sein.

Attention! Important mounting instruction. It shows risks to your life and health.

Attention! Indication de montage importante. Son non-observation peut mettre votre santé et votre vie en danger.

Die Gehäuseschelle ist mit einer Aussparung gefertigt, die zur Montage der Schelle von vorne, über das Gelenklager, dient.

The body clamp is manufactured with a groove to enable you to mount the clamp over the ball joint from the front side of the damper.

Le collier corps d'amortisseur est doté d'une rainure / épaulement qui permet d'enfiler le collier du corps d'amortisseur du côté de la rotule (attention de bien mettre le rotule dans l'axe de l'épaulement).

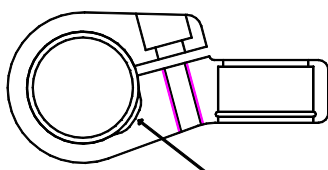

Aussparung / Groove / Rainure

Achten Sie unbedingt darauf, die Schrauben der Gehäuseschelle nicht zu stark anzuziehen, sonst kann die Lenkung des Motorrades beeinträchtigt und der Lenkungsdämpfer beschädigt werden. Der Spalt in der Klemmschelle sollte annähernd parallel verlaufen, wie in der Abbildung:

It's important that you do not tighten the screws too strong or the steering of the motorcycle won't work properly and the damper will be damaged. The gap in the body clamp should be aligned parallel as shown in the illustration:

Il est important de ne pas trop serrer les vis du collier d'amortisseur. Le serrage exagéré des vis peut porter préjudice au guidage de la moto et endommager le collier. Les deux côtés de la fente du collier doivent rester parallèles, comme indiqué dans le schéma ci-dessous :



Anzugsdrehmoment / Tightening torque / Couple de serrage M5x16 : 5 Nm



Fitting Instruction

Part-No. : **100Y088T**
 Product : **Steering damper**
 Manufacturer : **Yamaha**
 Model (Type) : **YZF-R1 (RN09) 2002 - 2003**

Mounted Steering damper



Parts list:

1 steering damper, 70mm stroke	→ „A“	2 spacers $\text{Ø}4 \times \text{Ø}8 \times 0.5$	→ „H“
1 body clamp $\text{Ø}22,3\text{mm}$	→ „B“	2 spacers $\text{Ø}4 \times \text{Ø}8 \times 1.0$	→ „J“
1 frame bracket, type	→ „C“	2 plastic plugs $\text{Ø}10 \times 11.5$	→ „K“
1 top yoke bracket, type	→ „D“	2 screws M5 x 16	
1 stainless chamfered bush, $\text{Ø}15 \times 6$	→ „E“	1 screws M6 x 40	
1 O-Ring, 12x3mm	→ „F“	1 screw M8 x 30	
1 bushing $\text{Ø}14 \times 2.9 \times 12$	→ „G“	1 screw M8 x 35	

Check for completeness

Important! If you are not a trained motorcycle mechanic stop now. Ask a local motorcycle shop to do the work for you.

Please make sure that the steering damper is not used as a steering stop! Check all screw connections at last and start with lowest damping for first ride!

If not otherwise mentioned, the following tightening torques are recommended: M5 = 5Nm/3.7lbf ft, M6 = 10Nm/7.4lbf ft, M8 = 20Nm/14.8lbf ft

Position of the body clamp	
	<p>1. Fix body clamp (B) on the steering damper (A) as shown. Follow the fitting instruction that is attached to the body clamp (B).</p>

Fitting the frame bracket

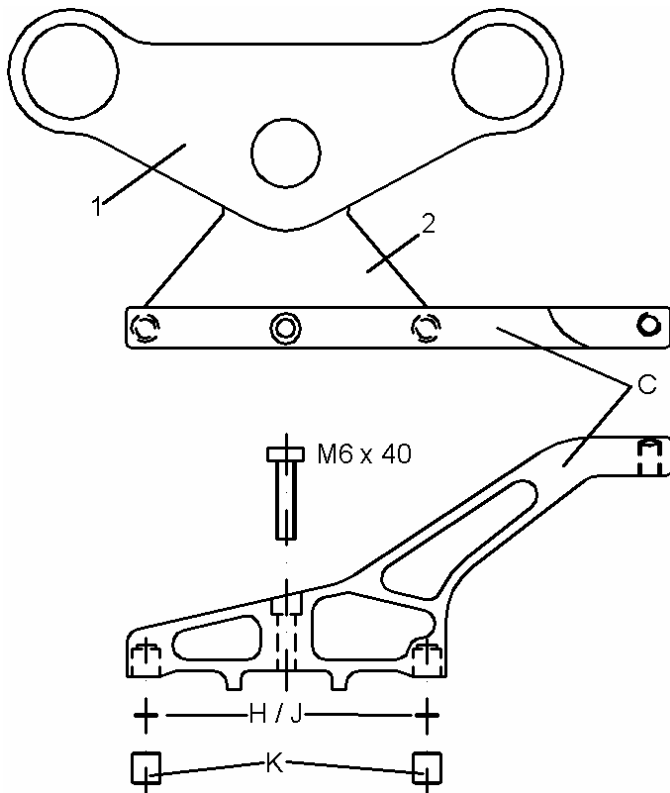

2. First mount the plastic plugs (K) from underneath into the frame bracket (C), then fit the frame bracket (C) with screw M6x40 on the frame (2) as shown, using the mounting point of the tank strap. **Assure there is no clearance between the plastic plugs (K) and frame (2) after installation. If the bracket (C) doesn't fit the frame (2) firmly, a damage of the tank strap and its thread would be the result. If any clearance occurs you have to use the spacers (H & J), to solve the problem.**

Fitting the top yoke bracket

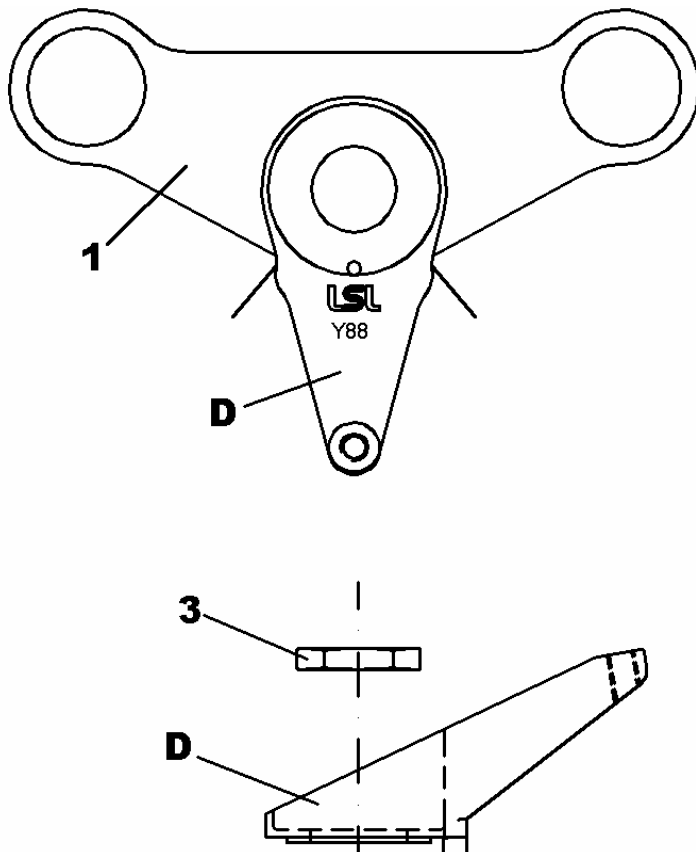

3. Now mount top yoke bracket (D) and original nut (3), with 115Nm/84.8lbf ft torque, on the top yoke (1), as shown. It's recommended to use a thin-walled socket wrench to avoid scratches on the bracket's inside (D) when tightening the nut (3).

Fitting the steering damper

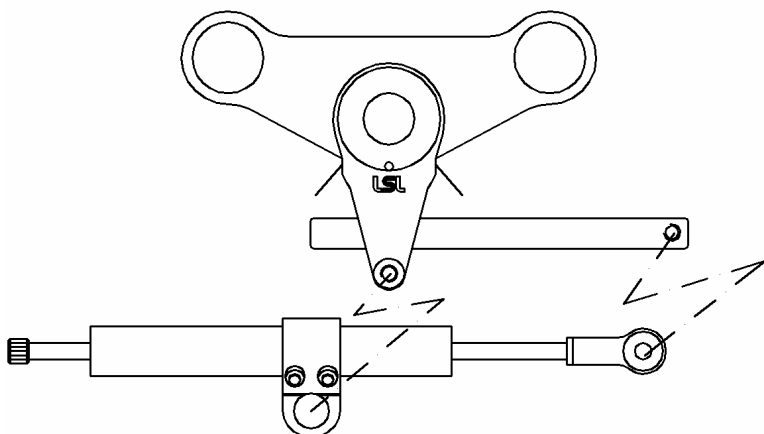

Fitting the body clamp

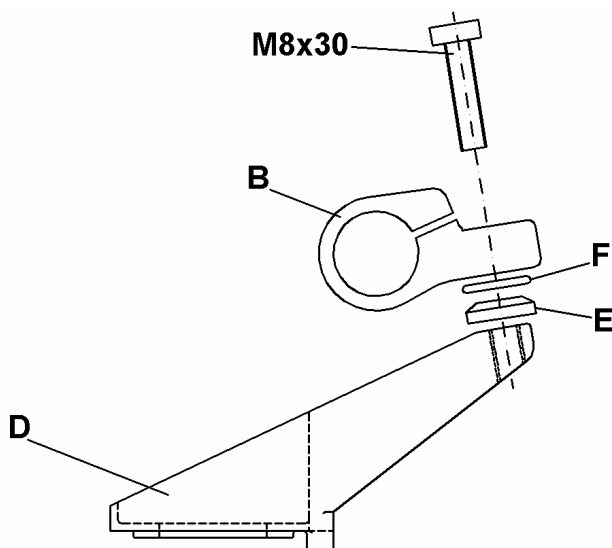

Fitting the damper rod

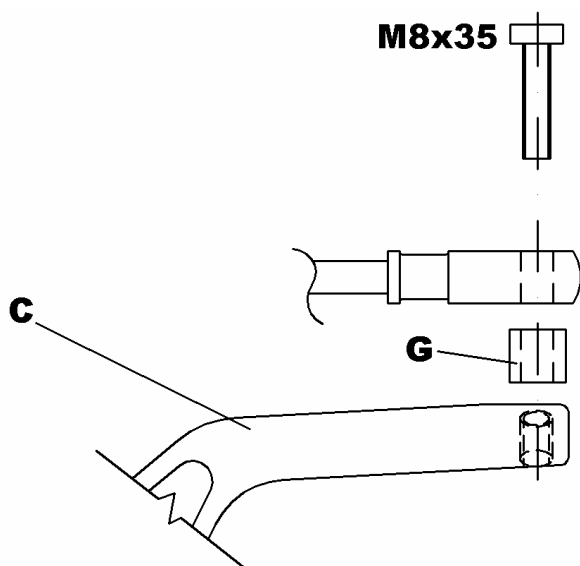

4. Fit the body clamp (B) first with screw M8x30, stainless chamfered bush (E) and O-Ring (F) on the top yoke bracket (D) as shown.

5. Then mount the damper rod with screw M8x35 and bush (G) on the frame bracket (C) as shown.

Please make sure that the steering damper is not used as a steering stop! Check all screw connections at last and start with lowest damping for first ride!